

PRESTRESSED CONCRETE CONSTRUCTION

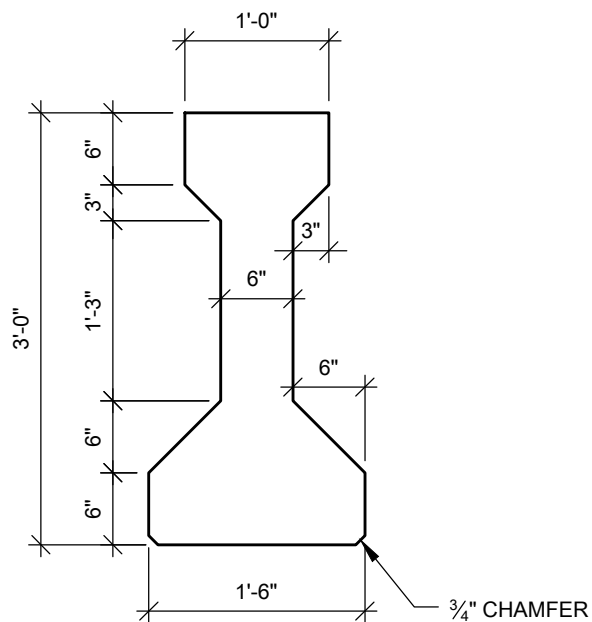

P.O. Box 311 - Newton, Kansas 67114
Phone: 316-283-2277 Fax: 316-283-2321
www.preconc.com

K2 GIRDER - ALL LOADINGS SPAN RANGE TO APPROX 65'



SECTION PROPERTIES

WT = 385 plf
A = 369 in²
I = 50,979 in⁴
Yb = 15.83 in
Sb = 3,220 in³
St = 2,527 in³