

# PRESTRESSED CONCRETE CONSTRUCTION

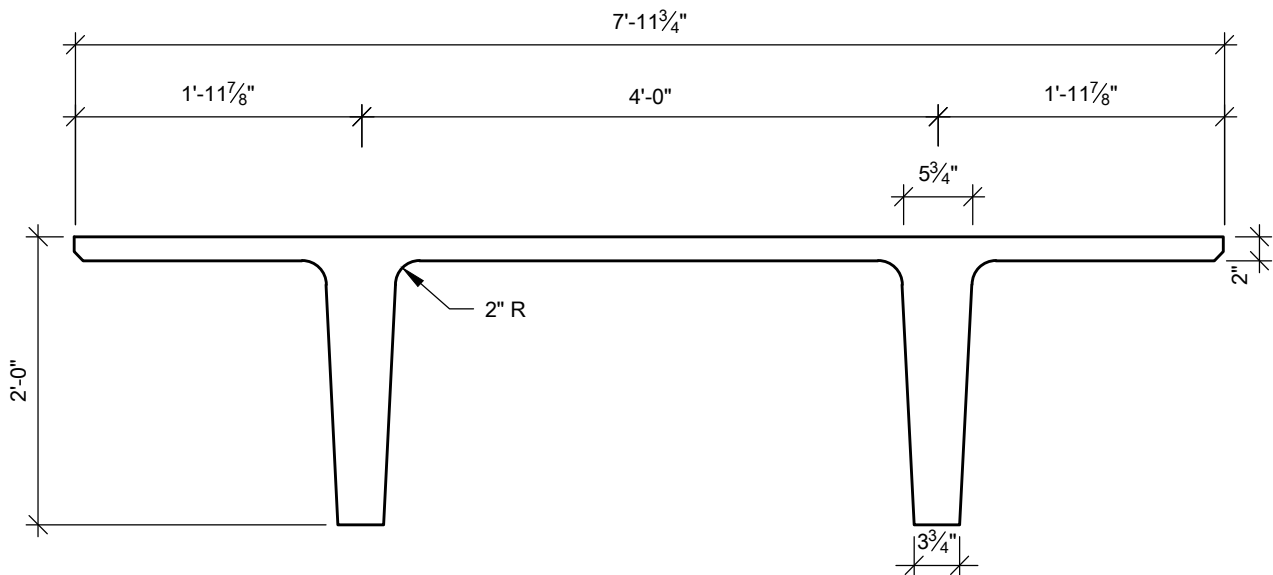

P.O. Box 311 - Newton, Kansas 67114  
Phone: 316-283-2277 Fax: 316-283-2321  
[www.preconc.com](http://www.preconc.com)

## 8'-0" DOUBLE TEE 24" DEEP



### SECTION PROPERTIES

WT = 418 plf  
A = 401 in<sup>2</sup>  
Y<sub>t</sub> = 6.85 in  
Y<sub>b</sub> = 17.15 in  
S<sub>b</sub> = 1,224 in<sup>3</sup>  
S<sub>t</sub> = 3,064 in<sup>3</sup>  
I = 20,985 in<sup>4</sup>